

Swing Check Valve-S15



Investment casting body

Pressure Rating: 200 PSI (PN16)

Working Temperature: -25 ~180°C

Medium : Water, Oil, Gas

Material : 304, 316, 1.4308, 1.4408, CF8, CF8M

Thread:ASME B1.20.1 BS21.DIN2999/259,

ISO228-1,JIS B 0203,ISO7/1

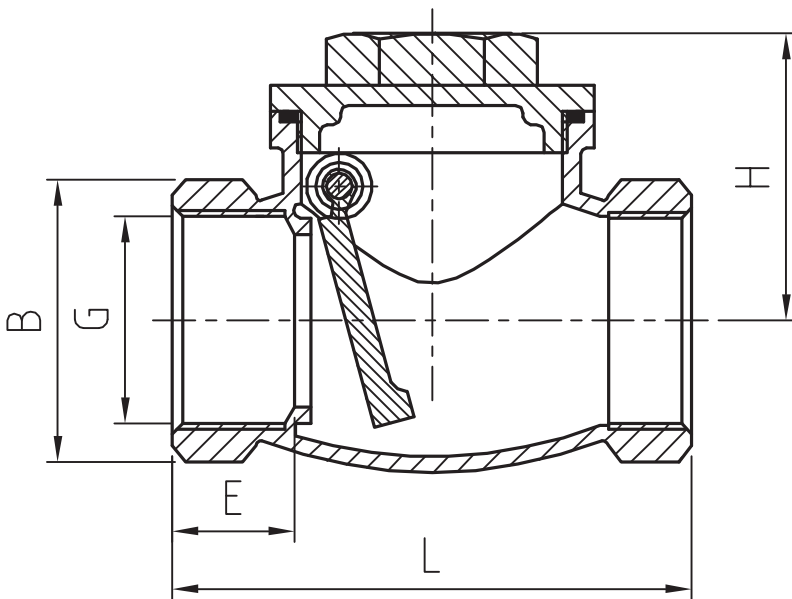

Main component materials:

Description Of Parts	Material
Body	SS304/316
Bonnet	SS304/316
Valve flap	SS304/316
Gasket	PTFE

Dimension:(mm)

SIZE	DN	L	E	B	H
1/2"	15	64	12	26	45
3/4"	20	80	17	32	53
1"	25	90	20	41	60
1-1/4"	32	105	20	51	64
1-1/2"	40	120	20	58	76
2"	50	140	23	69	82
2-1/2"	65	165	27	86	89