

SEGO WATER METERS

SJ-SDC PLUS

Single-Jet Dry Type (Velocity)



SEGO SJ-SDC PLUS is IMPELLER (turbine), single jet water meter with dry type register for residential application with sizes from Dn15 to Dn25 and meets to International Standard ISO 4064 and EN14154 standard R160.

Characteristics:

- All the Materials in contact with water, consciously selected by the known resistance to corrosion;
 - Cold water meter under current standard for lower than 30°C (T30), but NWM SJ-SDC PLUS can be used safely in water temperature up to 50°C (T50);
-

SEGO

WATER METERS SJ-SDC PLUS

- The **ROTARY** indicator register for the most comfortable reading position;
- The Impeller is the only moving parts in contact with water permitting the most reliable;
- The conception of the Magnetic Protection to against the external influences;
- No need for external adjustment due to its design and high technology in manufacturing;
- High accuracy for Horizontal installation;

Dial Plate Design:



Dimension:

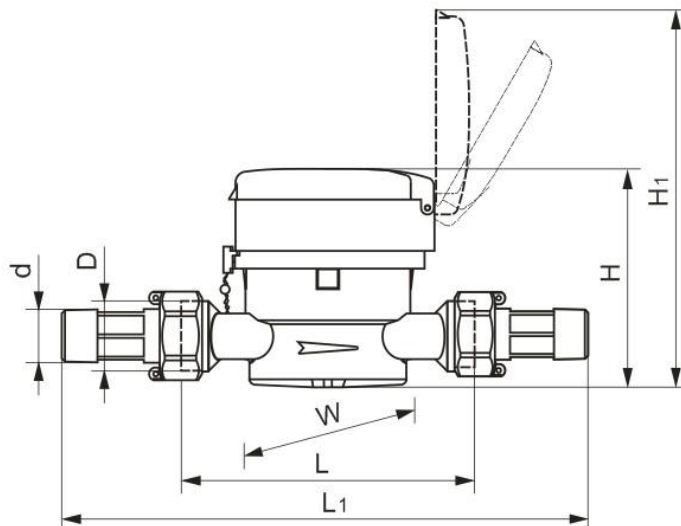

Size	Dn15	Dn20	Dn25	Dn32	Dn40
L	110	130	160	160	200
L1	204	234	280	284	331
D	G3/4B	G1B	G1-1/4B	G1-1/2B	G2B
d	R1/2	R3/4	R1	R1-1/4	R1-1/2
H	84.5	84.5	106	106	123
H1	145.5	145.5	167	167	184
W	81.5	81.5	84	84	110

L1: the total length with connection and the gasket without compression.

Main Technical Data:

Size	Dn	Dn15	Dn20	Dn25	Dn32	Dn40
R	Q3/Q1	160				
Q4	m ³ /h	3,125	5	7,875	12,5	20
Q3	m ³ /h	2,5	4	6,3	10	16
Q2	l/h	25	40	63	100	160
Q1	l/h	15,625	25	39,375	62,5	100
Max. Reading	m ³	99999,9999				
Min. Reading	Liter	0.02				
Pressure Loss	ΔP	63				
Max. Pressure	MAP	16				
Max. Temperate	T	T30 or T50				

Max. Permission Error (For T30):

From Q1 inclusive up to but excluding Q2 is $\pm 5\%$;

From Q2 inclusive up to and including Q4 is $\pm 2\%$;

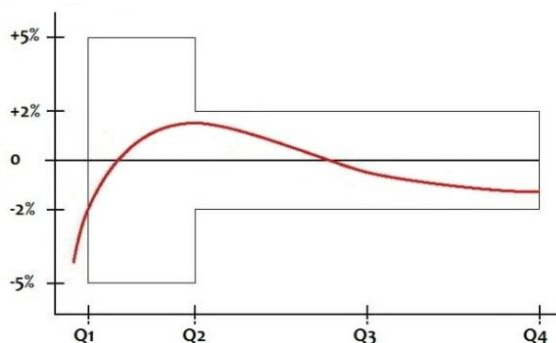

SEGO WATER METERS

SJ-SDC PLUS

Option for the Indication Register:



AMR Ready System as:

